

DISASSEMBLY

CAUTION:

Wear safety gloves, because the sharp edges and surfaces of the seat frame may cause injury to the hands.

HINT:

Tape the screwdriver tip before using it to remove the parts.

1. REMOVE OCCUPANT CLASSIFICATION ECU (See page [RS-154](#))

2. REMOVE HEADRESTS

3. REMOVE SEAT HINGE COVER LH

Remove the 2 screws and seat hinge cover LH.

4. REMOVE SEAT HINGE COVER RH

Remove the 2 screws and seat hinge cover RH.

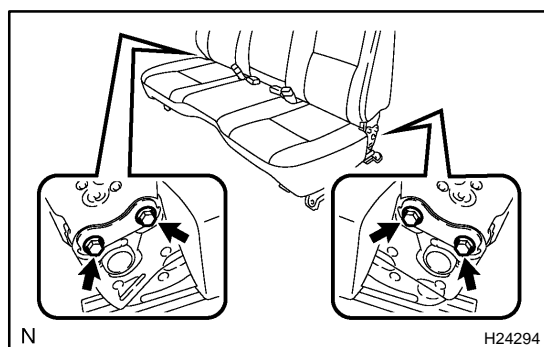

5. REMOVE SEATBACK ASSEMBLY

Remove the 4 bolts and seatback assembly.

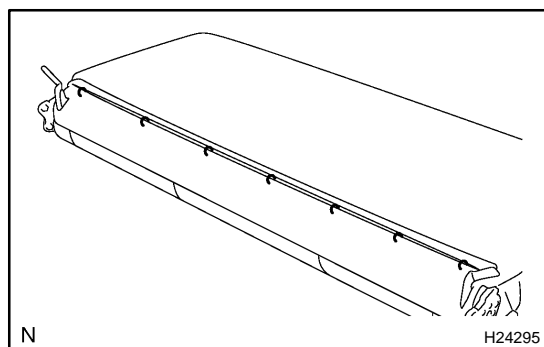

6. REMOVE CENTER ARMREST ASSEMBLY

(a) Remove the hog rings and turn the seatback cover over.

(b) Remove the 2 nuts and center armrest assembly from the seatback frame.

7. REMOVE SEATBACK FRAME

(a) Remove the 6 headrest supports from the seatback assembly.

(b) Remove the 2 screws and shoulder belt guide.

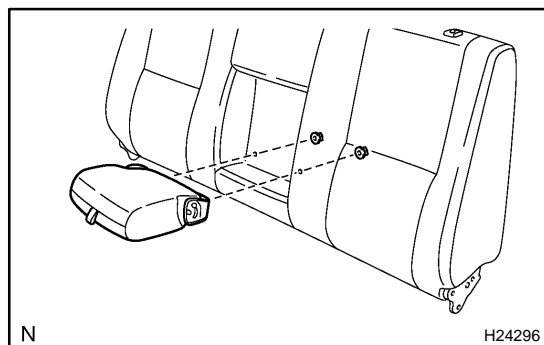

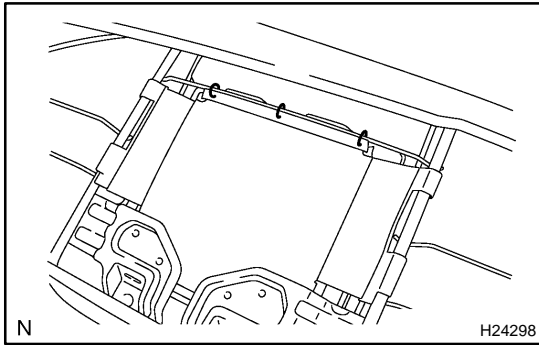

- (c) Remove the hog rings from the seatback frame.
- (d) Remove the seatback frame from the seatback pad and cover.

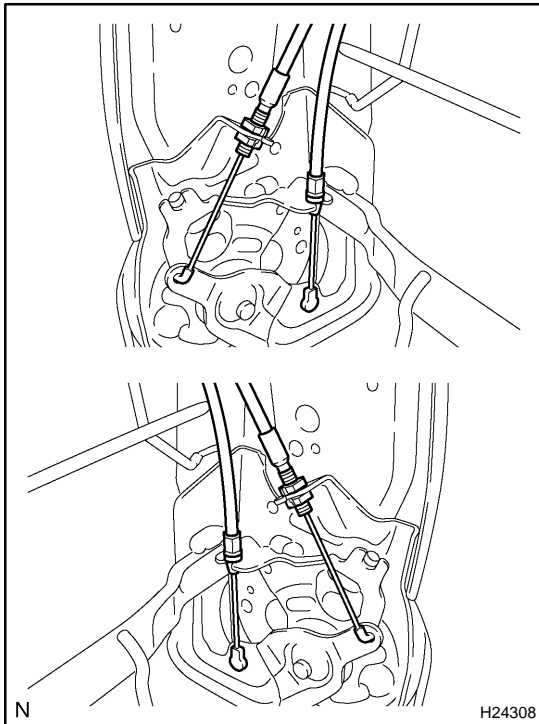

- (e) Disconnect the clamp.
- (f) Loosen the adjusting nuts.

HINT:

When loosening the nuts, hold one and loosen the other.

- (g) Perform the same procedure on the other side.
- (h) Remove the reclining adjusting cables.

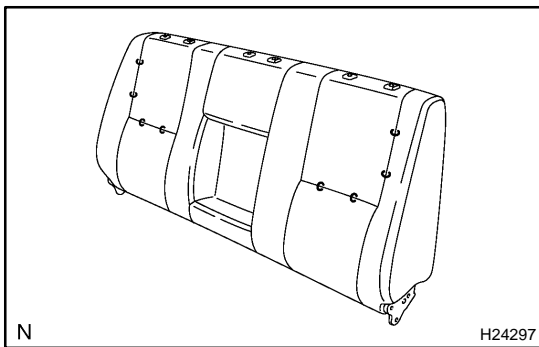
**8. REMOVE SEATBACK COVER**

Remove the hog rings and seatback cover.

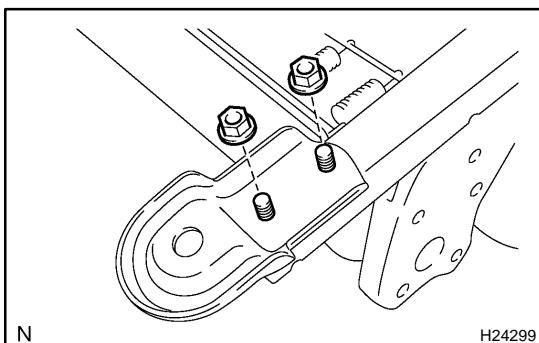
9. REMOVE SEAT POSITION SENSOR (For Driver Seat)
(See page [RS-118](#))**10. REMOVE SEAT POSITION SENSOR**
(For Front Passenger Seat) (See page [RS-145](#))**11. REMOVE 2 SEAT TRACK LOWER REAR BRACKETS**

- (a) Remove the 2 nuts and seat track lower rear bracket.
- (b) Perform the same procedure on the other side.

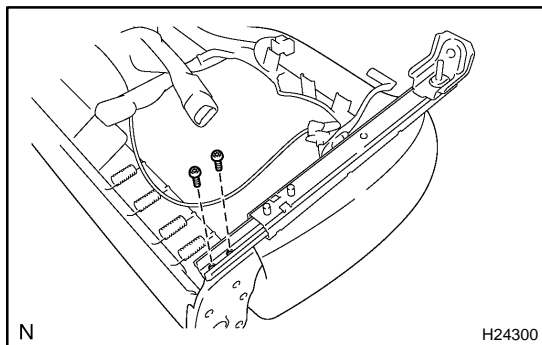
**12. REMOVE LH OUTER TRACK ASSEMBLY**

- (a) Slide the LH outer track assembly until the torx® screws on the rear side can be seen.
- (b) Using a torx® socket wrench, remove the 2 torx® screws from the LH outer track assembly rear side.

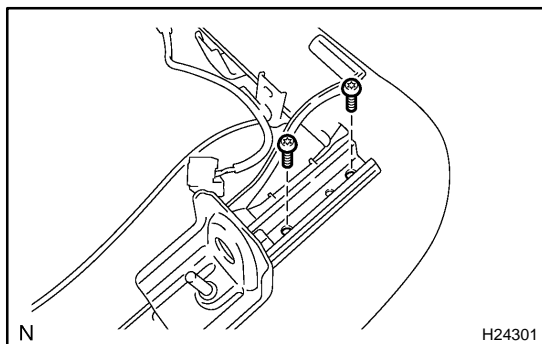

- (c) Slide the LH outer track assembly until the torx® screws on the front side can be seen.
- (d) Using a torx® socket wrench, remove the 2 torx® screws from the LH outer track assembly front side, and remove the LH outer track assembly.

13. REMOVE RH OUTER TRACK ASSEMBLY

HINT:

Perform the same procedure on the other side.

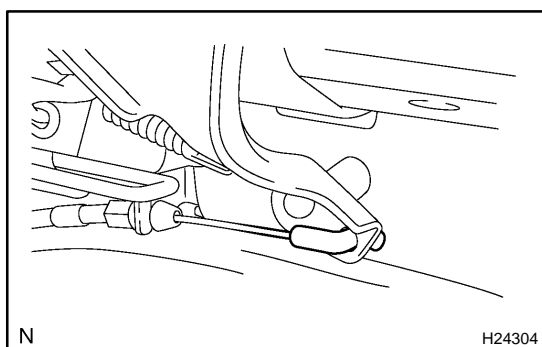
**14. REMOVE SEAT TRACK HANDLE LH**

- (a) Disconnect the seat track control cable.

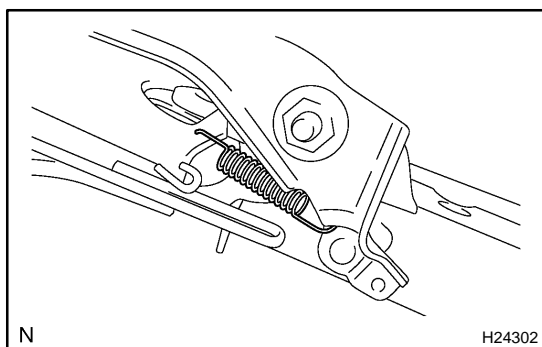

- (b) Remove the spring.

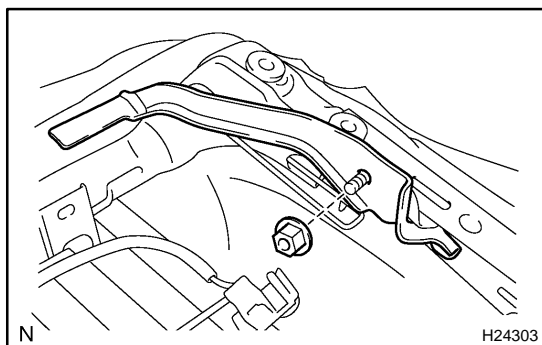

- (c) Remove the nut and seat track handle LH.

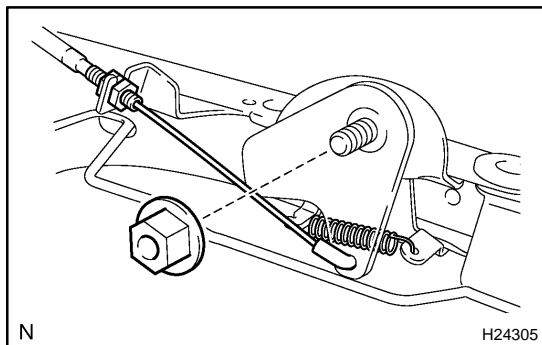
**15. REMOVE SEAT TRACK HANDLE RH**

- (a) Loosen the adjusting nuts.

HINT:

When loosening the nuts, hold one and loosen the other.

- (b) Disconnect the seat track control cable.
(c) Remove the spring.
(d) Remove the nut and seat track handle RH.

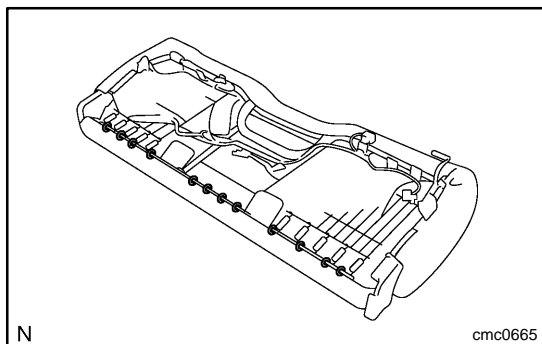
**16. REMOVE SEAT CUSHION FRAME**

- (a) Remove the hog rings.
(b) Cut the band clamps.
(c) Disengage the clips.
(d) Remove the seat cushion frame from the seat cushion pad and cover.

HINT:

If the seat cushion cover needs to be replaced, replace it with the front seat cushion assembly (service kit) (see page [RS-160](#)).

17. REMOVE OCCUPANT CLASSIFICATION SENSOR
(See page [RS-160](#))